

N.E. 1/4

37-1

SECTION 20, T.7N., R.1 W., S.L.B. & M.

TAXING UNIT 01

NORTH OGDEN DISTRICT

PREFIX 16-037

SCALE 1" = 200'

ALSO SEE PAGES 37-2, 3, 4

PARCEL Nos.  
0008, 0009

SEE  
PAGE  
37-4

EDNA R. WILLSON, EXECUTRIX  
OF EDNA R. WILLSON

0008

80 AC±

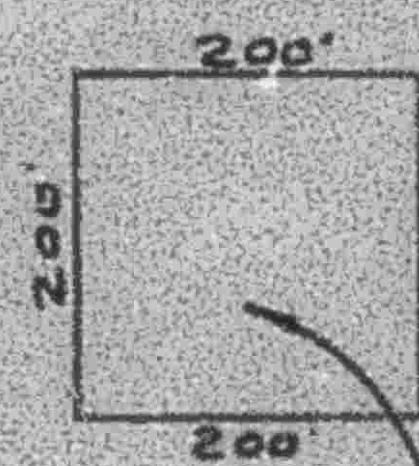

BEN LOMOND  
INVESTMENT  
CO. INC.  
-CLAIMS-

STREET

EAST

450

EDMOND H. WILLSON & 1/2  
EDNA MAY WILLSON & 1/2

0009

151.73 AC± IN ALL